

# Finding your Way Around University Hospital East

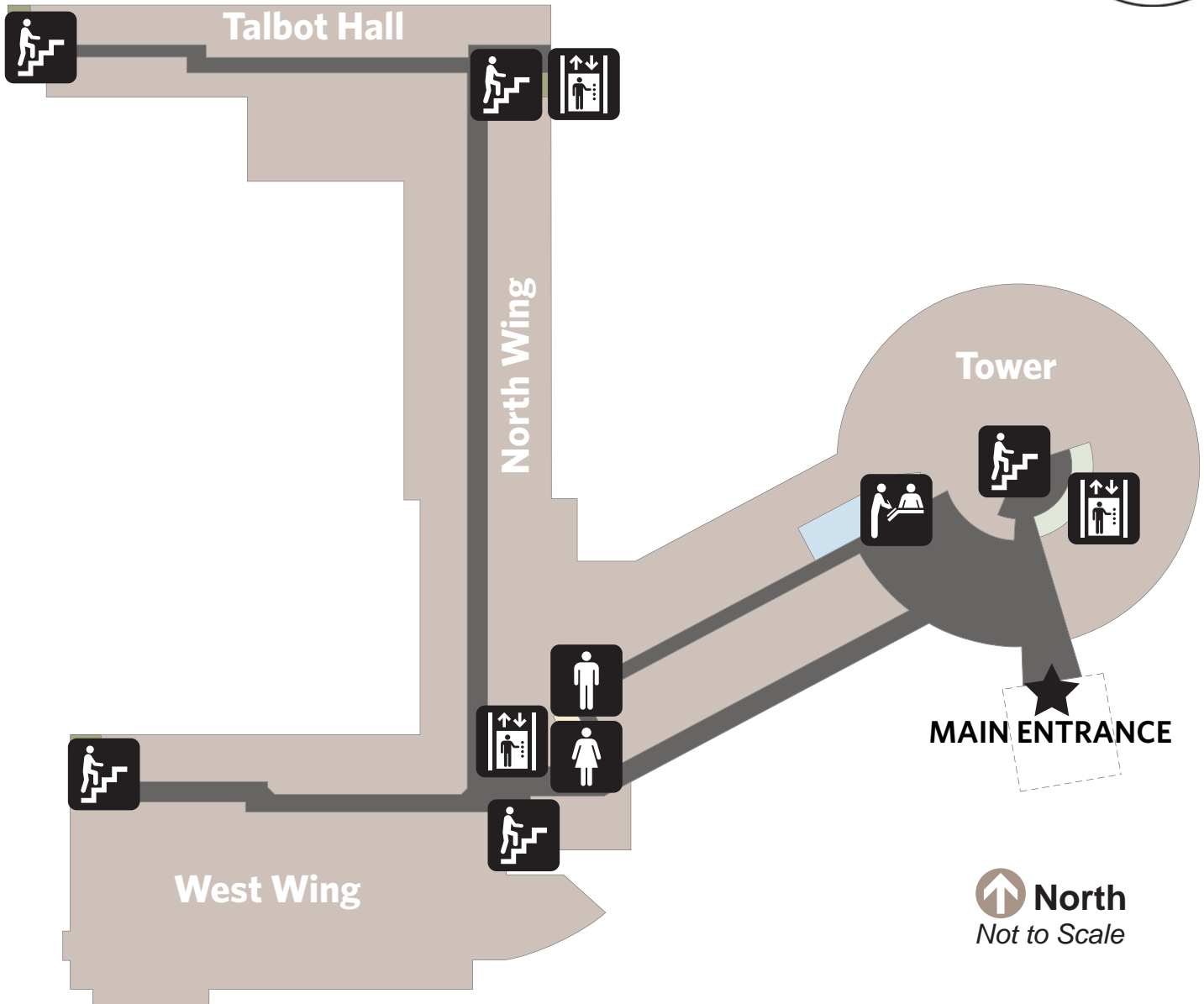

**North**  
Not to Scale

## University Hospital East

1492 East Broad Street  
Columbus, OH 43205  
(614) 257-3000

recorded directions:  
1 (800) 293-5123

[www.medicalcenter.osu.edu](http://www.medicalcenter.osu.edu)

## FLOOR 1

### LEGEND

- |              |                 |
|--------------|-----------------|
| REGISTRATION | MENS RESTROOM   |
| ELEVATORS    | WOMENS RESTROOM |
| STAIRS       | ENTRANCE        |

Smoking and the use of tobacco products are not permitted inside or outside of any OSU Medical Center building.



04-27-2011

# Finding your Way Around University Hospital East

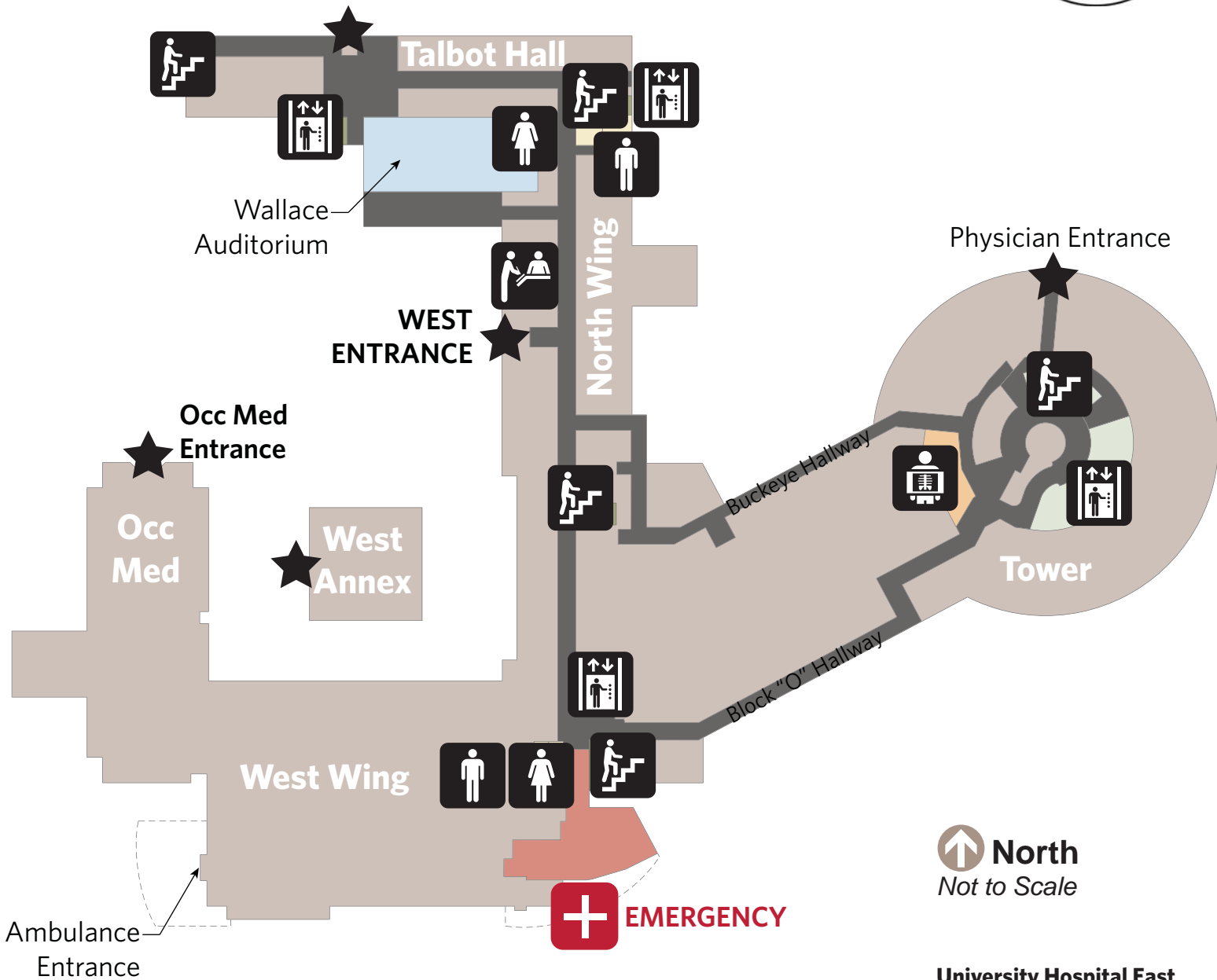

**North**  
Not to Scale

**University Hospital East**

1492 East Broad Street  
Columbus, OH 43205  
(614) 257-3000

recorded directions:  
1 (800) 293-5123

[www.medicalcenter.osu.edu](http://www.medicalcenter.osu.edu)

## FLOOR 2

**LEGEND**

- |              |                 |           |
|--------------|-----------------|-----------|
| REGISTRATION | MENS RESTROOM   | EMERGENCY |
| ELEVATORS    | WOMENS RESTROOM | ENTRANCE  |
| STAIRS       | RADIOLOGY       |           |

Smoking and the use of tobacco products are not permitted inside or outside of any OSU Medical Center building.



# Services at University Hospital East

## Services and Departments

### **Addiction Medicine**

Talbot Hall - Floor 2

### **Administration**

Tower - Floor 1

### **Admitting**

Tower - Floor 1

### **Ambulatory Care Center**

Tower - Floor 1

### **ATM**

West Wing - Floor 1

Tower - Ground Floor

### **Cafeteria/Seasons Garden Cafe**

Tower - Ground Floor

### **Cardiac Rehabilitation**

West Wing - Floor 1

### **CT Scan**

Check In at West Registration

North Wing - Floor 2

### **Dialysis**

Tower - Floor 4

### **EEG/EMG**

Check In at West Registration

Talbot - Floor 4

### **Emergency**

West Wing - Floor 2

### **Endoscopy**

Tower - Floor 1

### **Gift Shop**

West Wing - Floor 1

### **Human Resources**

West Wing - Floor 1

### **Hyperbaric Medicine**

Tower - Floor 9

### **Information Desk**

Tower - Floor 1

### **Intensive Care Unit (ICU)**

West Wing - Floor 4

(Summer 2011 moving to West Wing - Floor 3)

### **JamesCare (Oncology)**

Tower - Floor 7

### **Mammography**

Tower - Floor 2

### **Medical Information Management (Records)**

Tower - Ground Floor

### **Medical Library**

Tower - Floor 2

### **Medical Staff Office**

Tower - Floor 16

### **MRI**

North Wing - Floor 2

### **Occupational Medicine**

Occ. Med. Building - West Entrance

### **Occupational Therapy**

North Wing - Floor 1

### **Oncology/Hematology**

Tower - Floor 7

### **Outpatient Labs Testing**

West Annex - West Entrance

### **Department of Chaplaincy**

North Wing - Floor 3

### **Patient Rooms 301-326**

Tower - Floor 3

### **Patient Rooms 352-369**

West Wing - Floor 3

### **Patient Rooms 453-470**

West Wing - Floor 4 (ICU)

### **Patient Rooms N501-N526**

North Wing - Floor 5

### **Patient Rooms 602-629**

Tower - Floor 6

### **Patient Rooms 1002-1028**

Tower - Floor 10

### **Physical Therapy**

North Wing - Floor 1

### **Pre-Admission Testing**

West Annex - West Entrance

### **Pulmonary Rehabilitation**

West Wing - Floor 1

### **Radiology**

Tower - Floor 2

### **Registration - Tower (Admitting)**

Tower - Floor 1

### **Registration - West**

North Wing - Floor 2

West Entrance

### **Respiratory Therapy/EKG**

Tower - Floor 4

### **Sanctuary**

North Wing - Floor 3

### **Sleep Disorders Center**

Check In at West Registration

Talbot Hall - Floor 4

### **Speech Therapy**

North Wing - Floor 1

### **Surgery/ICU Waiting Area**

Tower - Floor 4

### **Talbot Classrooms**

Talbot Hall - Floor 2

### **Vascular Lab**

Tower - Floor 2

### **Vending Machines**

Tower - Ground Floor

### **Volunteer Services**

North Wing - Floor 3

### **Wallace Auditorium**

Talbot Hall - Floor 2

### **Wound Healing Center**

Tower - Floor 9