





# Finding Your Way Around University Hospital East

1492 East Broad Street (Taylor Ave. & E. Broad St.)



-  Elevators
-  Stairs
-  Restrooms
-  ATM  
(West Wing/  
Tower Ground Floor)
-  Cafeteria/Vending  
(Tower Ground Floor)

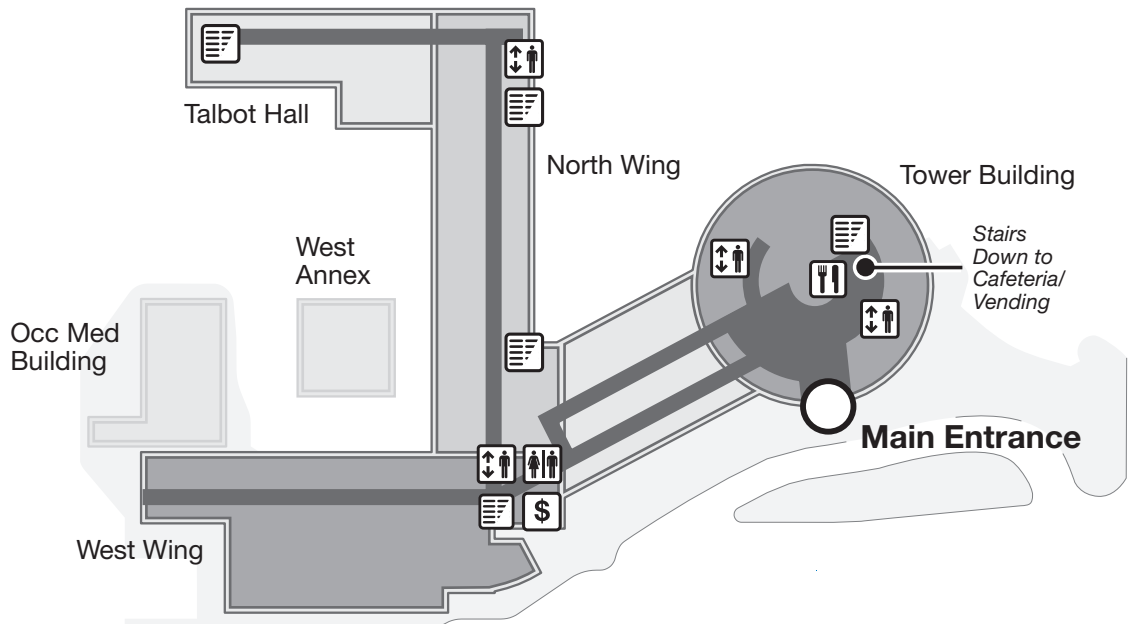

## Floor 1

### Services and Departments

(Walk to listed floor and follow directional signs or ask any staff member for assistance.)

<b>Addiction Medicine</b> Talbot Hall 2	<b>Endoscopy</b> West Wing 3	<b>Occupational Therapy</b> North Wing 1	<b>Registration – West</b> North Wing 2, West Entrance
<b>Administration</b> Tower 1	<b>Gift Shop</b> West Wing 1	<b>Oncology (JamesCare)</b> Tower 2,9	<b>Respiratory Therapy</b> Tower 4
<b>Admitting</b> Tower 1	<b>Human Resources</b> West Wing 1	<b>Outpatient Labs Testing</b> West Annex, West Entrance	<b>Sanctuary</b> North Wing 3
<b>Ambulatory Care Center</b> Tower 1	<b>Hyperbaric Medicine</b> Tower 9	<b>Pastoral Care</b> North Wing 3	<b>Sleep Disorders Center</b> (Check-In at West Registration) Talbot Hall 4
<b>ATM</b> West Wing 1 Tower Ground Floor	<b>Information Desk</b> Tower 1	<b>Patient Rooms 301–326</b> Tower 3	<b>Speech Therapy</b> North Wing 1
<b>Seasons Garden Cafe</b> Tower Ground floor	<b>Intensive Care Unit (ICU)</b> West Wing 4	<b>Patient Rooms 453–470</b> West Wing 4 (ICU)	<b>Surgery Waiting Area</b> Tower 4
<b>Cardiac Cath Lab</b> West Wing 5	<b>JamesCare (Oncology)</b> <i>Exam</i> —Tower 2 <i>Chemotherapy &amp; Pharmacy</i> — Tower 9	<b>Patient Rooms 501–527</b> Tower 5	<b>Talbot Classrooms</b> Talbot Hall 2
<b>Cardiac Rehabilitation</b> West Wing 1	<b>Mammography</b> North Wing 2	<b>Patient Rooms N501–N526</b> North Wing 5	<b>Vascular Lab</b> West Wing 5
<b>Credit Union</b> North Wing 1	<b>Medical Information Management (Records)</b> Tower Ground	<b>Patient Rooms 602–629</b> Tower 6	<b>Vending Machines/Cafe</b> Tower Ground
<b>CT Scan</b> (Check-In at West Registration) North Wing 2	<b>Medical Library</b> Tower 2	<b>Patient Rooms 1002–1028</b> Tower 10	<b>Veterans Services (VA)</b> West Annex, West Entrance
<b>Dialysis</b> Tower 4	<b>Medical Staff Office</b> Tower 16	<b>Physical Therapy</b> North Wing 1	<b>Volunteer Services</b> North Wing 3
<b>EEG/EMG</b> (Located within the Ambulatory Care Center) Tower 1	<b>MRI</b> North Wing 2	<b>Pre-Admission Testing</b> West Annex, West Entrance	<b>Wallace Auditorium</b> Talbot Hall 2
<b>Emergency</b> West Wing 2	<b>Occupational Medicine</b> Occ. Med. Bldg.—West Entrance	<b>Pulmonary Rehabilitation</b> West Wing 1	<b>Wound Healing Center</b> Tower 9
		<b>Radiology</b> Tower 2	
		<b>Registration – Tower</b> (Admitting) Tower 1	

# Finding Your Way Around University Hospital East

1492 East Broad Street (Taylor Ave. & E. Broad St.)



- Building Entrances**
- ① Talbot Hall
  - ② Wallace Auditorium
  - ③ West Entrance
  - ④ Occupational Medicine
  - ⑤ VA Preadmission Testing & Outpatient Lab
  - ⑥ Buckeye Radiation Oncology
  - ⑦ Emergency
  - ⑧ Physician Entrance
  - ⑨ Radiology
  - ⑩ Ambulance Entrance

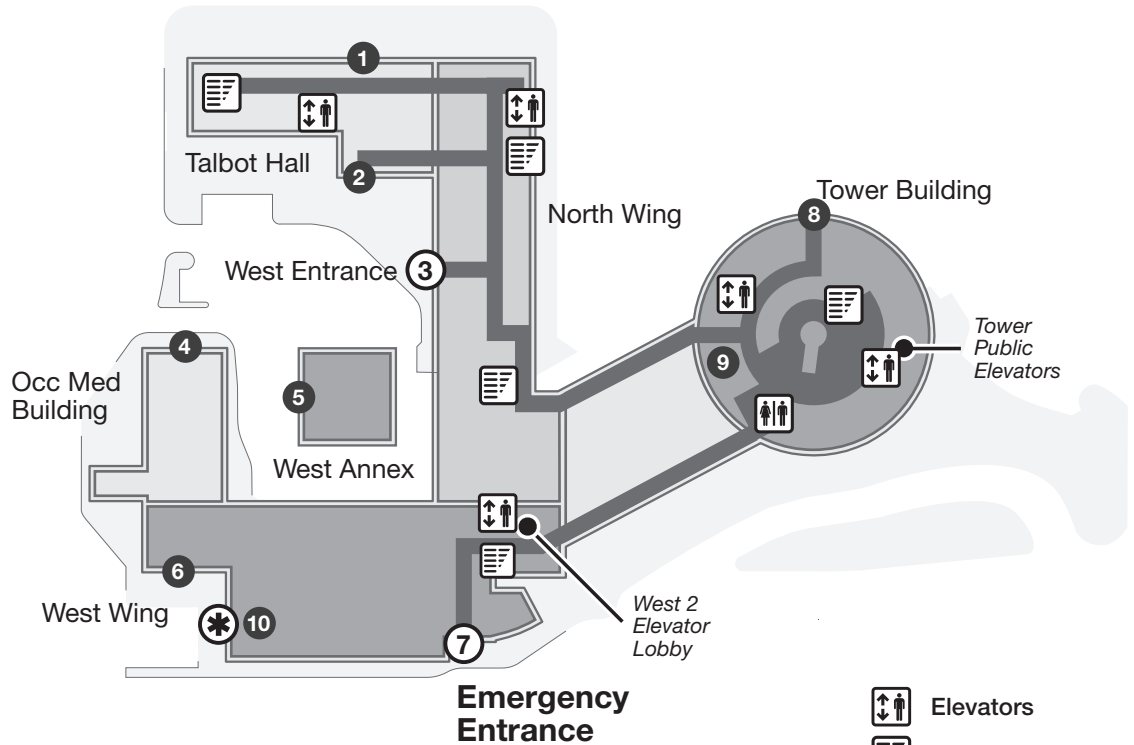

- Elevators
- Stairs
- Ambulance Entrance
- Restrooms

## Floor 2

### Services and Departments (See the other side for locations of services and departments)

Physicians in a variety of specialties have clinics or office practices at University Hospital East:

- |                              |                              |
|------------------------------|------------------------------|
| <b>Addiction Medicine</b>    | <b>Orthopedics</b>           |
| <b>Alternative Medicine</b>  | <b>Pain Management</b>       |
| <b>Cardiology</b>            | <b>Podiatry</b>              |
| <b>Digestive Diseases</b>    | <b>Pulmonary Medicine</b>    |
| <b>Family Practice</b>       | <b>Registration – West</b>   |
| <b>General Surgery</b>       | <b>Rheumatology</b>          |
| <b>Hematology/Oncology</b>   | <b>Sleep Medicine</b>        |
| <b>Internal Medicine</b>     | <b>Vascular Surgery</b>      |
| <b>Nephrology</b>            | <b>Wound Care/Hyperbaric</b> |
| <b>Neurology</b>             |                              |
| <b>Occupational Medicine</b> |                              |

*For current information about physicians with practice offices at University Hospital East, please see the directory at the Tower Elevators, ask at the information desk, or call 257-3160.*

Smoking and the use of tobacco products are not permitted inside or outside of any OSU Medical Center building.

Updated on January 7, 2008