

1st floor

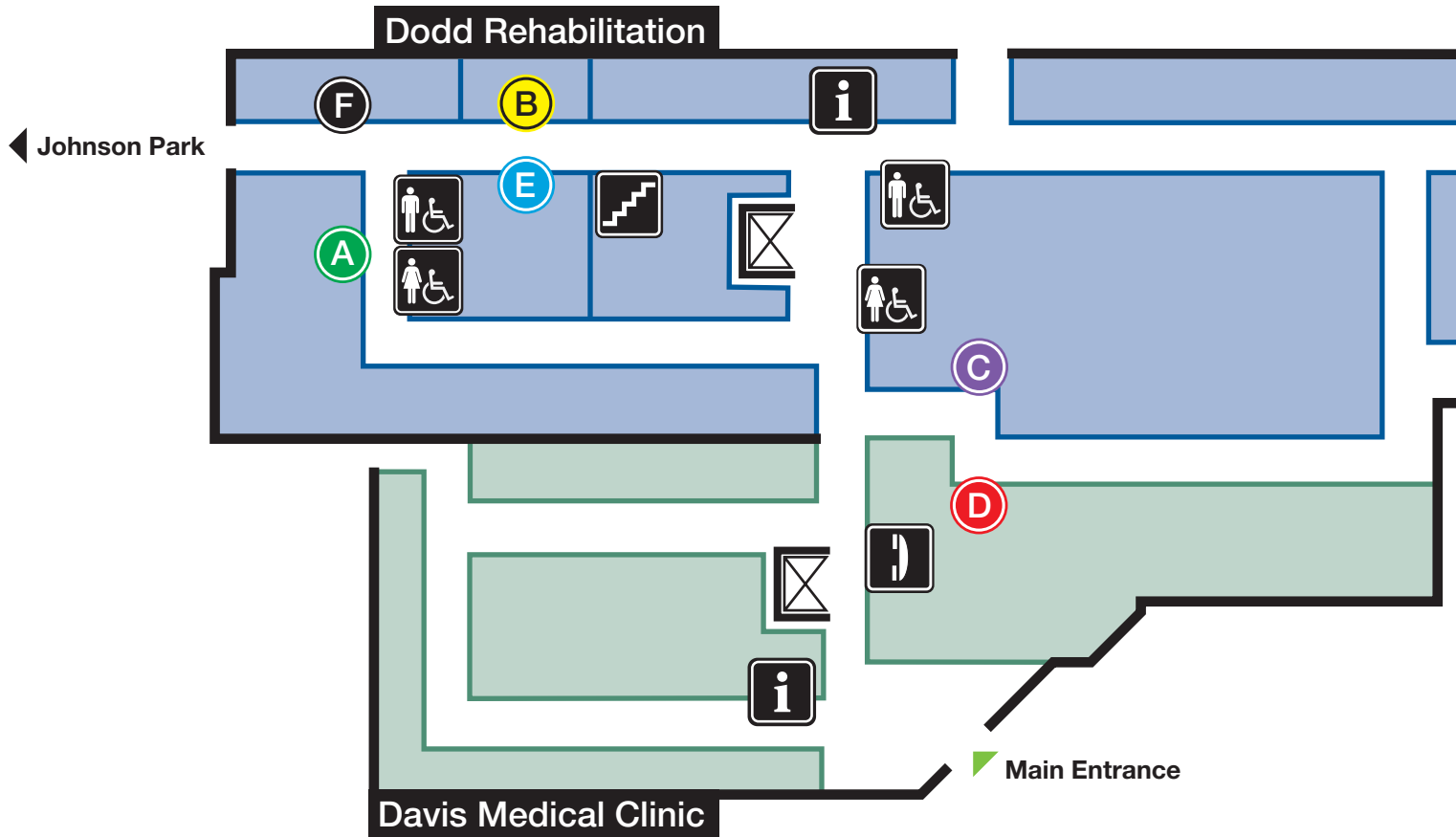

← Johnson Park

▲ Main Entrance

Map Key

- A Green Room
- B Yellow Room
- C Purple Room
- D Red Gym
- E Blue Gym
- F Independent Living Apartment
- Information Desk
- Women's Restrooms
- Men's Restrooms
- Telephone
- Elevators
- Stairwell



Smoking and the use of tobacco products are not permitted inside or outside of any OSU Medical Center building.

Updated on July 27, 2007